

Rolfe East



The Grove, Ealing

£500,000

- Two bedrooms
- Excellent condition
- Gas central heating
- No upper chain
- Garden flat
- 7 Minutes to Ealing Broadway Station
- Double glazed windows
- EPC rating: D / council tax band: E

A beautifully presented two double bedroom garden flat just minutes walk from Ealing Broadway Station and offered for sale with no upper chain.

The Grove is superbly located for the amenities and vast transports links of Ealing Broadway, and is walking distance to the large green open spaces of Ealing Common and Walpole Park. To arrange your viewing, please contact Rolfe East on 020 8567 2242.



Council Tax Band: E



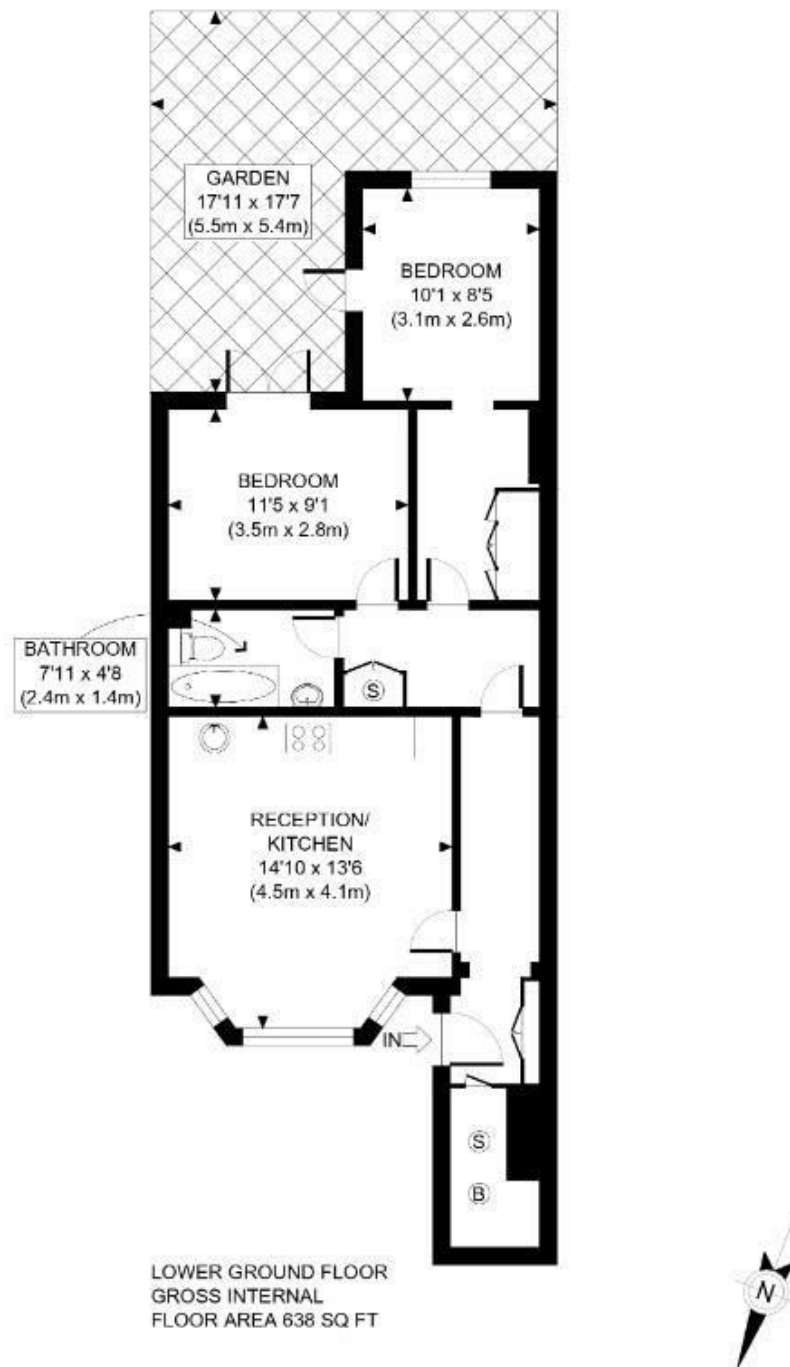

Directions

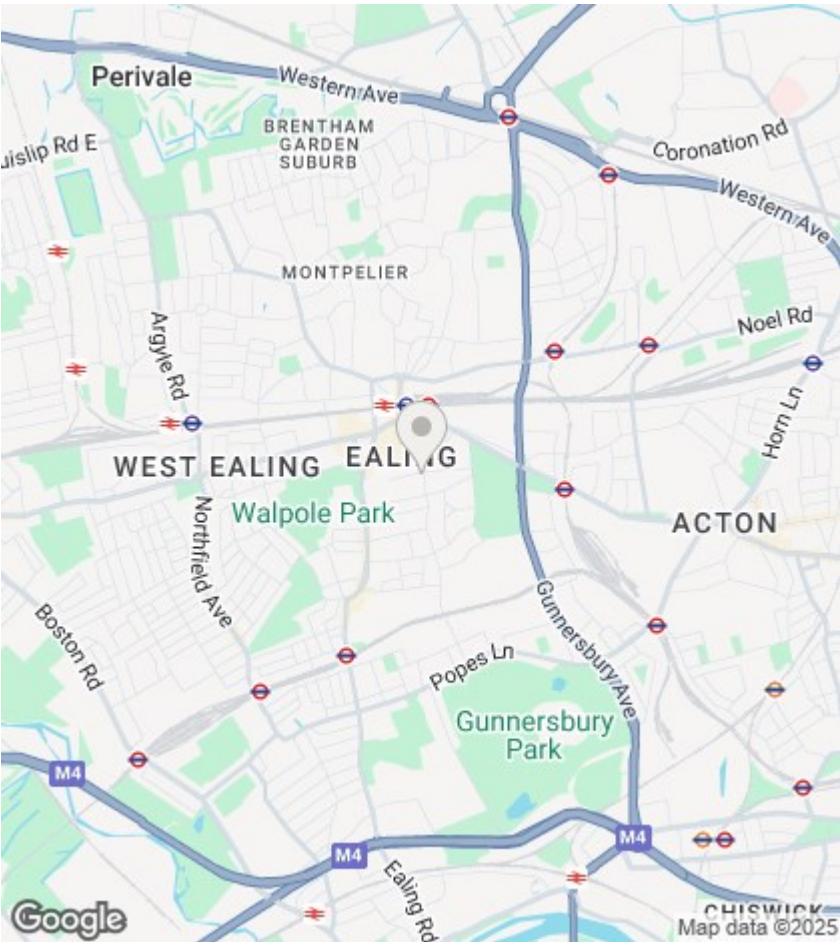

Viewings

Viewings by arrangement only.
Call 020 8567 2242 to make an appointment.

EPC Rating:

D

Energy Efficiency Rating		
	Current	Potential
Very energy efficient - lower running costs		
(92 plus) A		
(81-91) B		
(69-80) C		77
(55-68) D	68	
(39-54) E		
(21-38) F		
(1-20) G		
Not energy efficient - higher running costs		
England & Wales	EU Directive 2002/91/EC 